

Additional Remote Control Pairing Instructions

Please follow these step-by-step instructions to pair additional car remotes with the Garage Door Lock system.

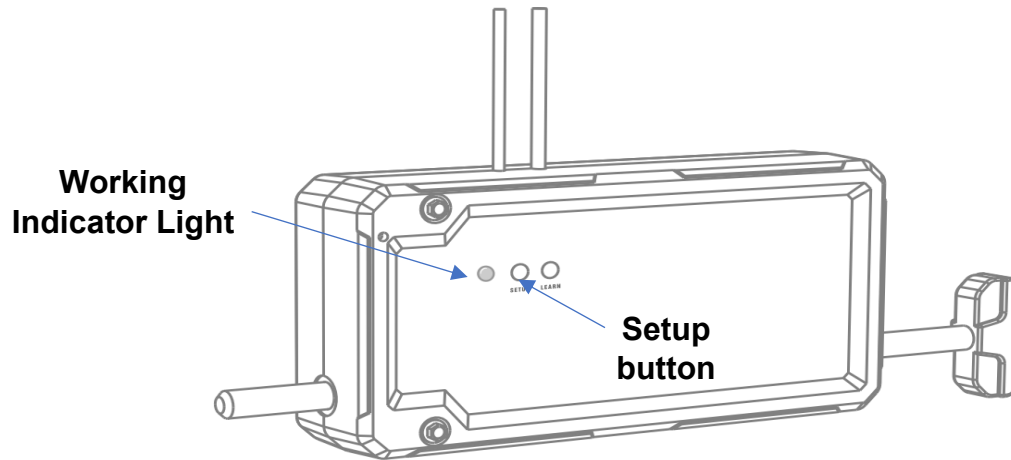

Figure 1: Lock Box

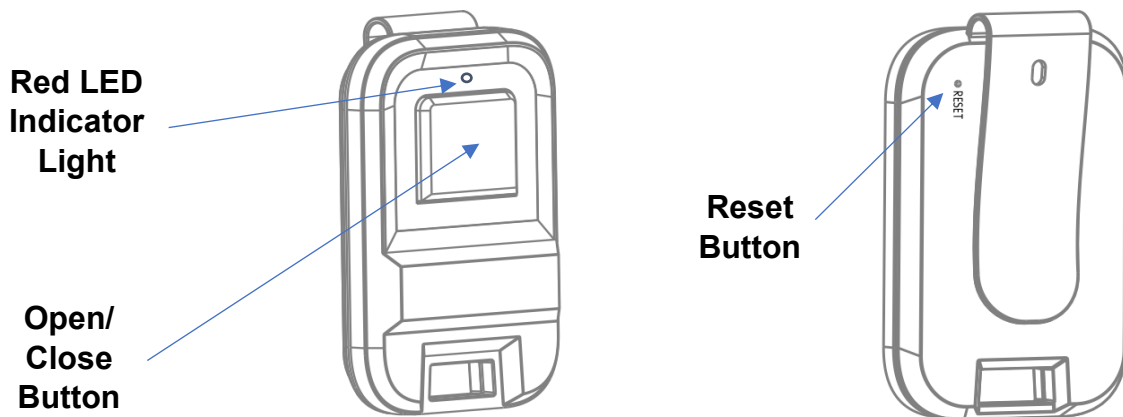

Figure 2: Remote Control

Steps:

1. Gather together the new car Remote Control and a needle
2. Short press the "Setup" button on the Lock Box (see Figure 1). The Working Indicator Light will turn to green and keep flickering slowly.
3. Press and hold down the "Reset" button (see Figure 2) on the Remote Control with a needle until the red LED indicator light turns on (about 4-5 seconds). The red LED light will flash quickly once and the second flash will stay on for about 2 seconds and then will turn off. At this point, the pairing should be complete and you can use your remote. Don't worry if the Working Indicator Light continues to flicker green... it will turn off automatically.

Notes:

1. If the configuration was **not** successful, the red indicator light on the Remote Control will flash on/off for 30 seconds then turn off automatically. If this happens, re-do step 3. Just make sure the Working Indicator Light on the Lock Box is still flashing green.